

LuciPac® Pen Aqua

From Kikkoman

For analysis of contamination of liquids via ATP/AMP measuring by Lumitester PD20, e.g. for contamination monitoring of waters and waste waters.

1. Introduction

Using the LuciPac® Pen Aqua sampling pen, liquids can be tested quickly and easily for organic contamination. The organic contamination of liquids, e.g. by bacteria, is indicated by the presence of ATP or AMP in these samples. An enzyme/substrate complex in the LuciPac® Pen Aqua sampling tube reacts with ATP and AMP to produce bioluminescence whose intensity correlates directly with the amount of ATP/AMP present. The Lumitester PD20 then determines the bioluminescence as a direct measure of original contamination. The sampling comb ensures precise sampling of 150 µl with a deviation of $\leq 2\%$. Test results are, therefore, highly reproducible and comparable. The unit is easy to operate, even by non-professionals. Just immerse the sampling comb into the liquid. Then put the comb back into the tube and push it down into the reaction chamber. Shake the tube until the reagents are released and measure the bioluminescence in the Lumitester PD20.

2. Shipment and storage

20 LuciPac® Pens Aqua each are packed in a resealable aluminium bag. Kits are to be stored at a low temperature (2 °C to 8 °C (35.6 °F to 46.4 °F)) for long term storage. The kit can be stored below 25 °C (77 °F) for up to 14 days or below 30 °C (86 °F) for up to 5 days before opening an aluminum bag without any adverse effect on the long term stability. Do not freeze the device. We recommend that you use all 20 sampling devices in a single bag at one time after opening an aluminum bag. If you have leftover sampling devices that you must store after opening a bag, be sure to store them at the recommended low temperature (2 °C to 8 °C (35.6 °F to 46.4 °F)) and use them within two weeks after opening. Expiry date: printed on the label of the aluminum bag. Store protected from light.

3. Comments on application, detection limits

The sampling stick (comb) of this device can collect up to 0.15 ml of water and ATP and/or AMP can be measured from 10^{-11} mol/l to 10^{-6} mol/l using LuciPac® Pen Aqua combined with Lumitester PD-20. Therefore, the minimum measurable level of bacteria would correspond to about 10^4 cells/ml calculated from said ATP content of 10^{-18} mol in a single bacterium. Please be aware that you cannot detect very low concentration of bacteria by this method.

For detection of very low amounts of bacteria, membrane filtering methods should be applied. Please filter some bigger amount of liquid (typically 100 ml) through a membrane filter. Subsequently, probe this filter with LuciPac®-Pen (Art. No. NC59.1) and measure using the PD-20.

This kit can be used to test cleanliness levels of water and other liquid samples. Do not use this device for any purpose other than what it was designed for as a tester of cleanliness levels of water, other liquid samples, or other application which is instructed to use by the manufacturer. Please be aware that this kit cannot be used to test or identify specific types of pathogenic bacteria.

Water and other liquid samples may contain ATP and/or AMP which are caused by improper cleaning of facilities or originate from microorganisms propagating in such samples. Since this device measures ATP+AMP levels immediately, indications of improper cleaning processes, e.g. inadequate microbiological control of coolant or other industrial process water can be promptly detected.

This device shall not provide any guaranty that a given test sample is free of bacterial contamination. Thus it is not suitable for microbial testing of originally ATP rich beverages, such as fruit juices. Also suitable for use with Lumitester PD30.

4. Mechanism

This kit uses an enzyme cycling method based on a combination of luminescent reactions from firefly luciferase and pyruvate, orthophosphate dikinase (PPDK). This method produces a given amount of luminescence that is proportional to the amounts of adenosine triphosphate (ATP) and adenosine monophosphate (AMP) present in the sample.

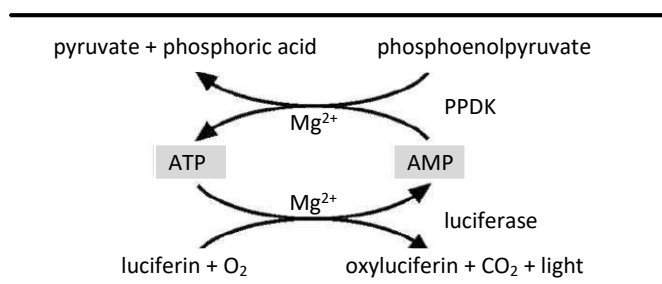

Firefly luciferase emits light in the presence of ATP and luciferin. The AMP produced from this reaction is converted back into ATP using PPDK to enable a high but stable amount of luminescence to be obtained. ATP is a source of energy necessary for various forms of life that is present in organic residues, such as microorganisms, food residues, and biological substances that originate from other living organisms. This method allows you to measure and detect organic residues and micro-organisms at high speed and high sensitivity by detecting ATP using luciferase, to monitor cleaning processes and microbiological control of coolant or other industrially processed water.

In addition, this kit can be used to measure not only of ATP but also of AMP amounts, the latter produced from the breakdown of ATP, to increase the range of application to an even wider range of organic residues.

5. Composition of product

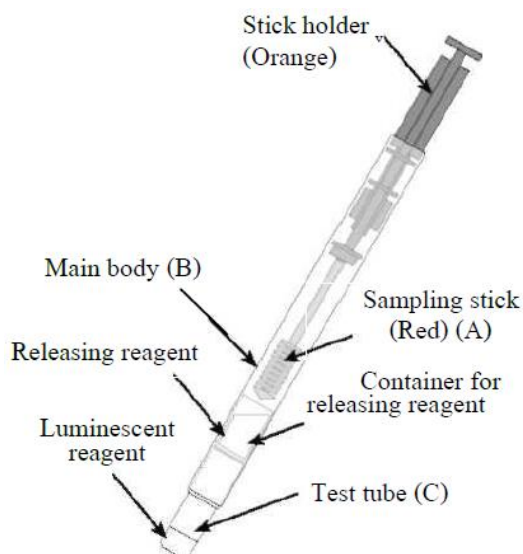

Reagent cocktail:
Luciferin, luciferase, phosphoenolpyruvate (PEP), magnesium acetate, pyrophosphopyruvate pyruvate/phosphate dikinase

Releasing reagent:
Alkyl dimethylbenzylammoniumchloride

<u>Structural parts</u>	<u>Raw material</u>
Stick holder (orange)	Polypropylene
Test tube (body)	Polypropylene
Sampling comb (red)	ABS Resin
Container for releasing reagent	Polypropylene, aluminium
Measurement tube	

6. Please note

Please make sure to follow the instructions outlined below in order to obtain optimal performance from this device.

1. Do not use products with a shelf life that has already expired. Expired products may not yield accurate results (the expiry date is printed on the label of the aluminum bag holding the sampling devices).
2. Be sure to use only designated products, i.e. type of Lumitester when performing luminescent measurements. This device cannot be used with unqualified products.
3. Prior to testing the sampling devices should be allowed about 20 min to reach room temperature (20 °C to 35 °C (68 °F to 95 °F)), if they are from a refrigerated stock. Measurement values may deviate from the real value, if the swabs are used without equilibration. Use the sampling devices as soon as possible once they are available at room temperature. Do not keep the device at temperatures exceeding 35 °C (95 °F). High temperatures may cause product performance to drop.
4. Wherever possible, be sure to use up all sampling devices from a single bag that has been opened at one time. However, If you must store leftover sampling devices once finished with a test session, firmly close the aluminum bag and store it in a refrigerated environment (2 °C to 8 °C (35.6 °F to 46.4 °F)). High temperatures may cause product performance to drop.
5. Do not subject the device or any part of it to direct sunlight for long periods of time. Strong light may cause product performance to drop.
6. Do not touch any of the parts inside the device, particularly not any part of the sampling stick (comb) itself with a finger or other object before use. Touching the parts may affect cleanliness levels, making them hard to discriminate.
7. Do not drop the device or any of its parts or allow any parts to be struck or jolted. The interior aluminum sheets and other parts in the kit may become damaged, causing product performance to drop.
8. Do not use the device if any parts become damaged, e.g. the inner aluminum sheets separating the reagent chamber from the comb as well as the luminescent reagent. Such damage will affect product performance. The aluminum sheet is not damaged if the releasing reagent stays in the chamber upon agitation.
9. Do not soak more than 3 cm from the tip of the sampling stick (comb) into water or other liquid samples. Water or other liquid samples which wet the shaft of the sampling stick (orange) may affect test results.
10. Ensure that the LuciPac® Pen Aqua is not shifted or displaced, discard the item, because accuracy cannot be guaranteed, swabs are not removable from the Lumitester PD-20, or the instrument may cause an error (malfunction)
11. If the test reagent is leaking please don't use the swab.

7. Measurement

Complete the procedures listed below within a temperature range of 20 °C to 35 °C (68 °F to 95 °F). Make sure to always run measurement tests at the same temperature to maintain repeatability for comparison. Remove the LuciPac® Pen Aqua from refrigerator and wait until they have reached room temperature (about 20 min, 20 °C to 35 °C (68 °F to 95 °F)). Use the sampling devices then as soon as possible.

1. Remove the sampling stick from the main body (casing).
2. Soak sampling stick about 3 cm from the tip of the sampling stick into water or other liquid samples, and shake gently. Make sure no bubbles remain within sampling stick's comb.
3. Pull out the sampling stick slowly and straight up from the sample.
4. Return the sampling stick to the main body (casing) and push it all the way into the main body.
5. Push firmly onto LuciPac® Pen Aqua casing and agitate.
6. Allow the leftover luminescent reagent to thoroughly dissolve.
7. Insert the LuciPac® Pen Aqua into the Lumitester to measure the results.

8. Short instruction

Prior to use, make sure the LuciPac® Pen Aqua sticks have come to room temperature. But then use immediately.

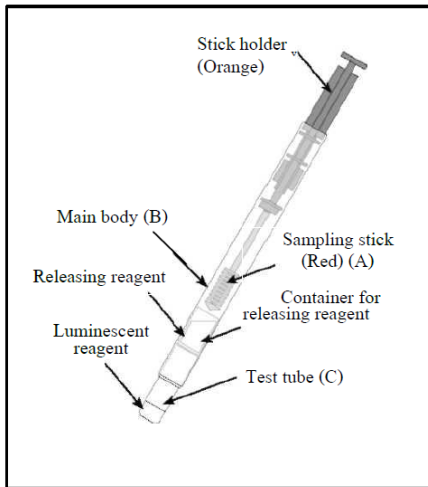

1

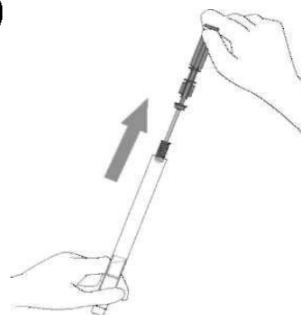

Pull the sampling stick (A) out of the main body (B). (Be careful not to touch the sampling stick.)

2

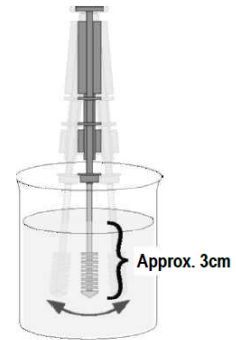

Soak sampling stick into water or other liquid samples and shake gently. Make sure no bubbles remain in sampling stick's comb.

3

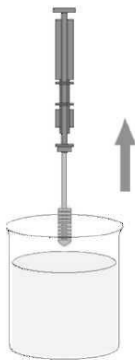

Pull out the sampling stick slowly and straight up from the sample.

4

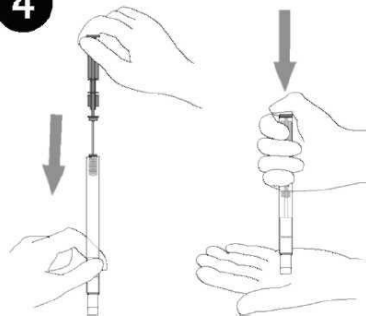

Put the sampling stick (A) back to the main body (B) and push it through all the way by putting the tip of the test tube (C) on a palm of hand or table. (Be careful not to get fingers caught when pushing it.)

5

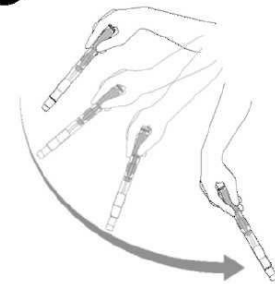

Shake the whole body of the LuciPac Pen-AQUA a few times so that the liquid in the capsule falls into the test tube (C).

6

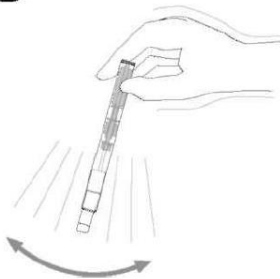

Gently shake the whole body of the LuciPac Pen-AQUA to completely dissolve the luminescent reagent.

7



Insert the whole body of LuciPac Pen-AQUA into the measurement chamber of Lumitester and close the chamber's cover.

8



Press the "ENTER" key. Results are obtained in 10 seconds.

1. Safety recommendations

Please observe the following items to ensure safe use of this product.

- Please note safety recommendations given in the Safety Data Sheet!
- Do not attempt to drink the kit reagent or touch it with bare hands or allow it to splash into eyes. Please make sure to read the precautions and instructions in this Instruction Manual before attempting to use the kit and exercise extreme caution when using it.
- Be careful not to get fingers caught when inserting the sampling stick into the main body (casing).
- Handle with care when storing and disposing of the device and its reagents to ensure that none of the substances become mixed with food and other products.
- Please make sure to store this kit and its parts out of the reach of young children.
- Take precaution when disposing of this kit after use to ensure that such substances do not become mixed with food products at food production centers and similar facilities.

LuciPac® Pen Aqua

20 pieces

NC58.1

100 pieces

NC58.2

Carl Roth GmbH + Co. KG

Schoemperlenstraße 3-5 • 76185 Karlsruhe
P.O. Box 100121 • 76231 Karlsruhe
Phone: +49 (0) 721/ 5606-0
Fax: +49 (0) 721/ 5606-149
info@carlroth.com • www.carlroth.com

sse 06/2021

The company is a limited partnership with headquarters in Karlsruhe, reg. court Mannheim HRA 100055. Roth Chemie GmbH, with headquarters in Karlsruhe, reg. court Mannheim HRB 100428, is the personally liable partner. Managing Director: André Houdelet. Sales tax identification number: DE 143621073.